

# ALPOLIC®

## MATERIALS

MITSUBISHI PLASTICS COMPOSITES AMERICA, INC.

### natural metals – copper

ALPOLIC® Copper Metal Composite Material finish features a natural Copper surface that evolves and weathers to a rich patina, adding character and depth to any building facade.

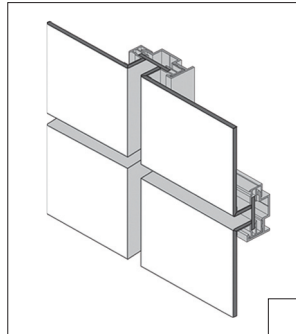

#### CONSTRUCTION INFORMATION

PROJECT: Ceridian Corporate Headquarters

ARCHITECT: Hammel, Green &

Abrahamson, Inc.

PRODUCT: ALPOLIC® Copper



#### GENERAL INFORMATION

Our Natural Metals Series is simply dazzling in both appearance and performance. It features the same flatness and workability of an aluminum composite material (ACM), but with the metal surface of your choice. Each 4mm metal panel is stocked in a polyethylene core and available for immediate shipment.



COPPER  
4-8C12

# ALPOLIC® copper

INTERIOR AND EXTERIOR SURFACING  
INTERIOR AND EXTERIOR SIGNAGE

## SURFACE TREATMENT

ALPOLIC® Copper Composite Material (CCM) is created by sandwiching two thin layers of copper around a polyethylene core. The genuine surface of copper will weather over time and turn to a classic patina green.

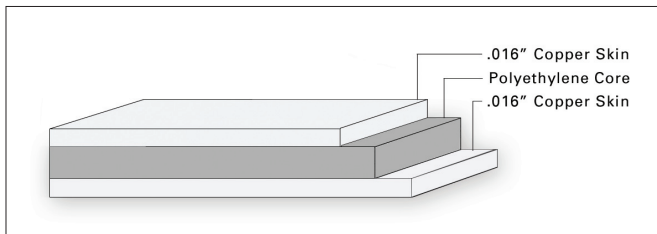

## STANDARD PANEL SIZE

Standard stock is 38" x 146" (965mm x 3708mm) in 30 piece crates. Custom lengths and thickness available. Please contact ALPOLIC® Customer Service for current available stock and additional information.

## FINISH TOLERANCE

Finish color of natural metal can't be controlled and some variation should be expected.

## PRODUCT TOLERANCE:

Width:	± 0.08" (2mm)
Length:	± 0.16" (4mm)
Thickness:	4mm: ± 0.008" (0.2mm)
Bow:	maximum 0.5% of length and/or width
Squareness:	maximum 0.2" (5mm)
Peel Strength:	>22 in lb/in (ASTM D17181)

ALPOLIC® material is trimmed and squared with cut edges to offer the best panel edge conditions in the industry.

## WARRANTY

Standard panel warranty: 10 Year  
Finish warranty: Not Applicable  
Call ALPOLIC® Customer Service for exclusions and warranty details.

## PRODUCT NOTES

- Copper needs to be isolated from aluminum and other dissimilar metals to avoid galvanic corrosion.
- Panels should be stored flat in a dry, indoor environment.
- Protective film should be removed from panels soon after installation.
- Please refer to CCM Fabrication Manual for routing and fabrication recommendations.
- Crating fees apply to orders for less than standard piece crate.

**FOR TECHNICAL INFORMATION, PLEASE  
CALL 1.800.422.7270**

### U.S. HEADQUARTERS

**MITSUBISHI PLASTICS COMPOSITES AMERICA, INC.**

401 Volvo Parkway, Chesapeake, VA 23320

Telephone: 800-422-7270, Facsimile: 757-436-1896

www.alpolic-northamerica.com e-mail: info@alpolic.com